

DESTACKER

A large stack of unpopulated PCB's is placed above the ESD belt conveyor. Unique separation cams take one PCB from the bottom of the stack and lowers it onto the ESD belt conveyor.



STANDARD
SERIES





**STANDARD
SERIES**

DESTACKER

STANDARD FEATURES

- > Short PCB cycle time.
- > Controlled by PLC.
- > Thin PCB capability.
- > By-pass mode selectable without removing PCB stack.
- > Conveyor width adjustment using hand crank.
- > Towerlight display for machine status.
- > Pre-warning low stack sensor.
- > CE certified.

OPTIONS

- > Electrical conveyor width adjustment
- > Automatic conveyor width adjustment
- > Extension 200 mm for convenient stack loading
- > Cantilevered input- or output conveyor (length 500 mm)
- > Touchscreen display
- > Alarm buzzer

Other options available on request

GENERAL MACHINE SPECIFICATION

Transfer height	950 mm ± 25 mm*
Colour	RAL 9002*
Flow direction	Left to right*
Fixed rail	Front*
Machine interface	SMEMA*
Conveyor concept	ESD belt
Belt speed	14 m/min.
PCB edge support	3 mm
Components clearance (by-pass)	Top 30 mm, bottom 30 mm
Power supply	230 VAC/50 Hz/1 Ph
Power consumption	150 VA max.
Air supply	4-6 bar
Air consumption	5 ltr/min max.
PCB cycle time	± 10 seconds
Diameter suction pads	15 mm
PCB thickness capability	0.6 mm - 4.0 mm
PCB stock capacity	220 mm

** or specify*

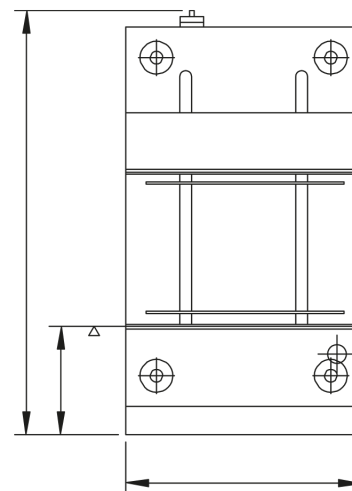

MACHINE SIZES	NTM220DSM	NTM220DSL	NTM220DSXL
Machine L x W x H (mm)	500 x 905 x 1300	500 x 905 x 1300	653 x 960x 1300
Weight (Kg)	150	150	160
PCB Length (mm)	80 - 457	80 - 457	80 - 460*
PCB Width (mm)	70 - 250	70 - 407	75 - 460*
Fixed rail to front (A) (mm)	234	234	234

** or specify*